

**Ordinance 2023-21 to create a Planned Unit Development known as Nance Street International Residence Hall Planned Unit Development and to rezone ~7.62 acres at the corner of Robert Grissom Pkwy & Mr. Joe White Ave (PIN 425-13-01-0080) from HC2 (highway commercial) to PUD (Nance Street International Residence Hall Planned Unit Development) to provide safe housing for seasonal international workers.**

---

Planning Commission: 4/4/2023, voted unanimously 5/0 to recommend approval with the further recommendation that City Council and the developer consider ways in which the project can cohesively blend into the neighborhood, and that the public improvements are properly financed and executed.

**Proposed Location**

**Robert M Grissom Pkwy**



# Current Zoning

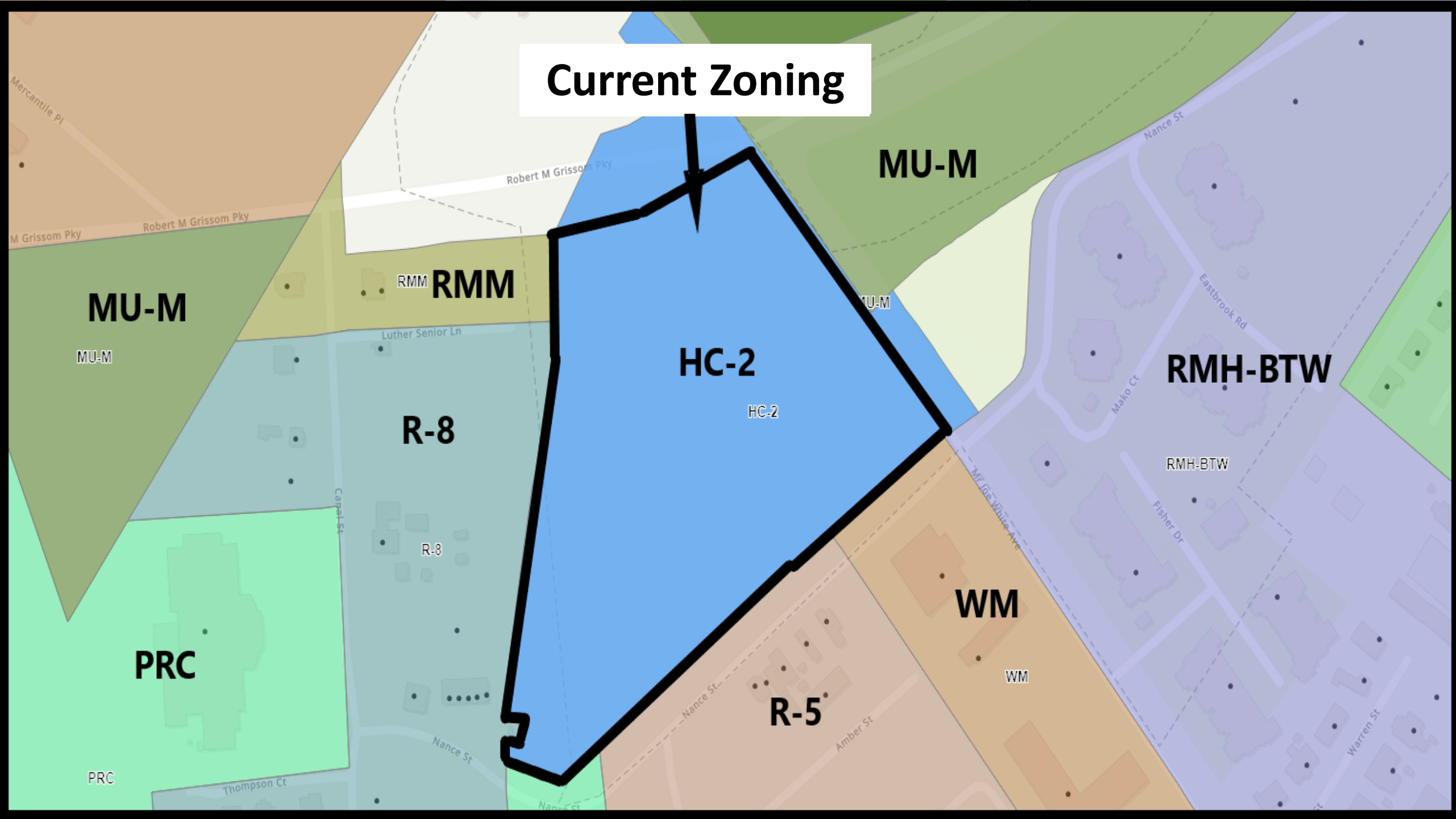



<b>UNITS PER BUILDING</b>	<b>81</b>
<b>OCCUPANTS PER BUILDING</b>	
<b>BUILDING 1</b>	<b>314</b>
<b>BUILDING 2</b>	<b>310</b>

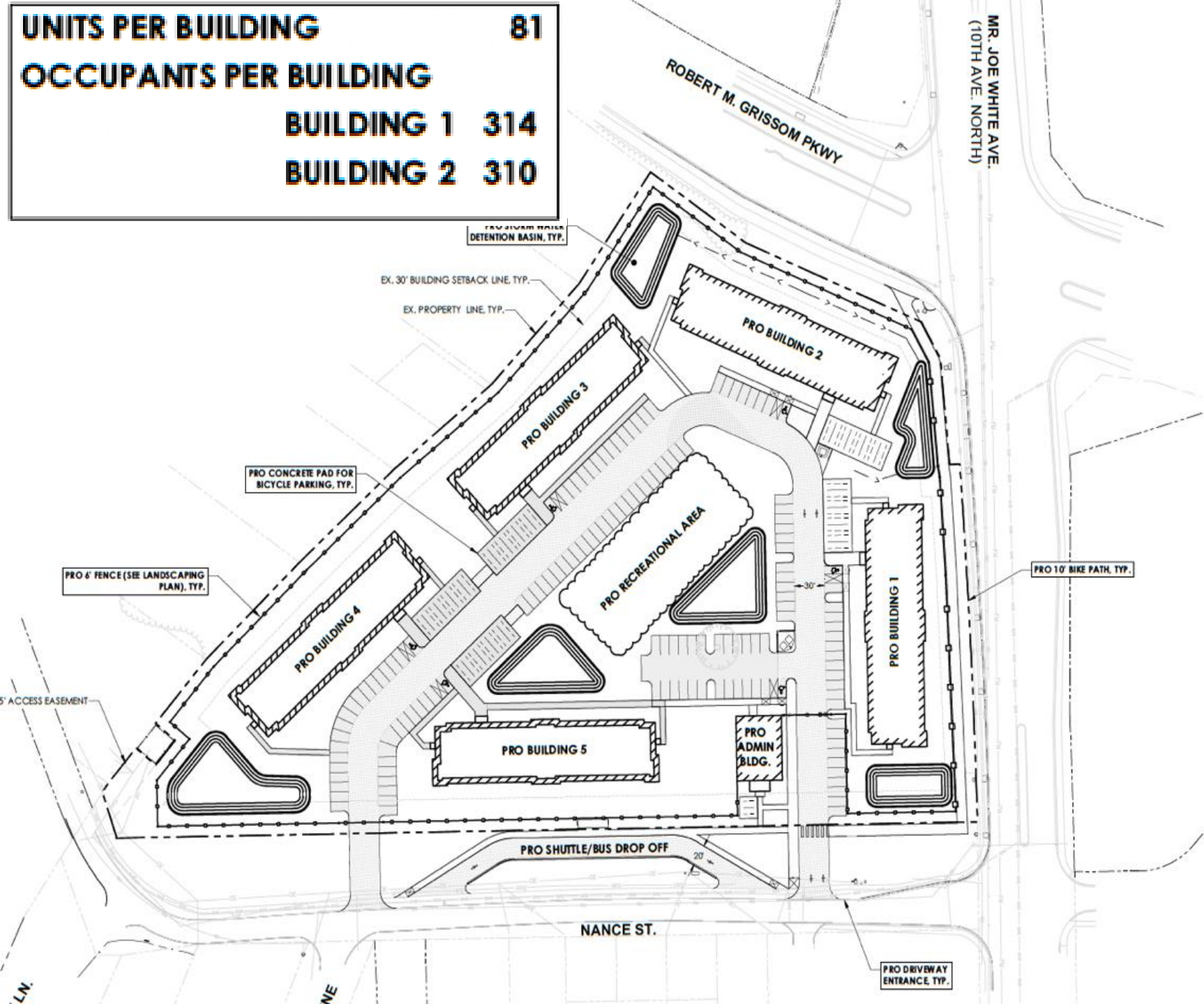

## Proposed Site Plan

### PUD Details:

- Only permitted use is dorm style residences & related amenities.
- Reduced Car Parking, Increased Bicycle Parking
- 6' Fence on All Sides

**Phase One: 2 Years**  
**Final Phase: 6 Years**

# Public Improvements

UNDERGROUND UTILITY LOCATIONS ARE  
AND SHOULD BE FIELD VERIFIED PRIOR TO

NOTES FOUND ON SHEET G1.1.

LDING 81  
PER BUILDING  
BUILDING 1 314  
BUILDING 2 310

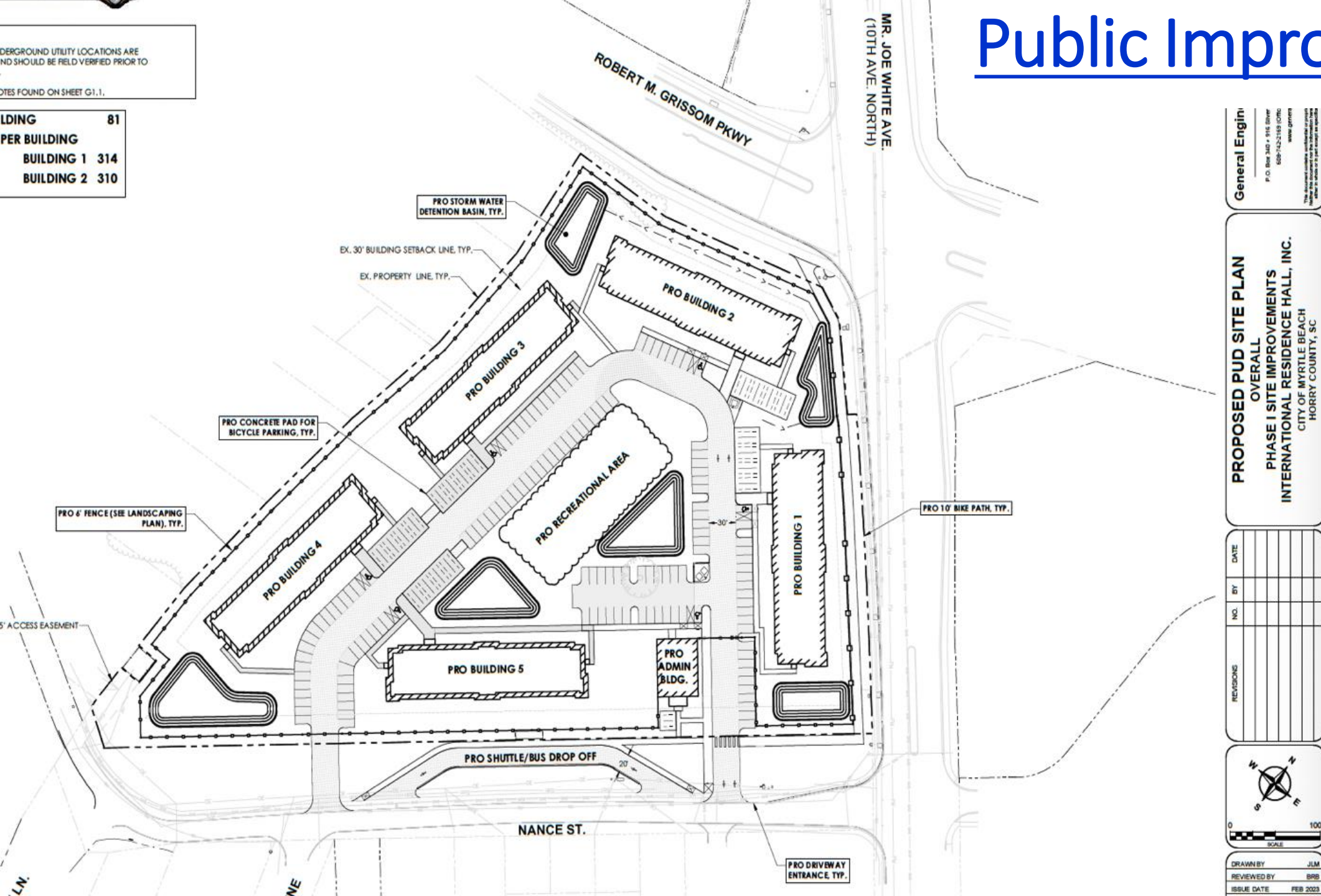

General Engineer

P.O. Box 340 • 916 Silver  
689-142-2189 (C/O)  
www.gemco.com

This document is the property of the engineer and is not to be reproduced or used in any way without the written consent of the engineer.

PROPOSED PUD SITE PLAN  
OVERALL

PHASE I SITE IMPROVEMENTS  
INTERNATIONAL RESIDENCE HALL, INC.  
CITY OF MYRTLE BEACH  
HORRY COUNTY, SC

REVISIONS	NO.	BY	DATE



DRAWN BY JLM  
REVIEWED BY BRB  
ISSUE DATE FEB 2023



# Public Improvements

## Stormwater Improvements to alleviate existing Harlem Neighborhood Drainage Issues

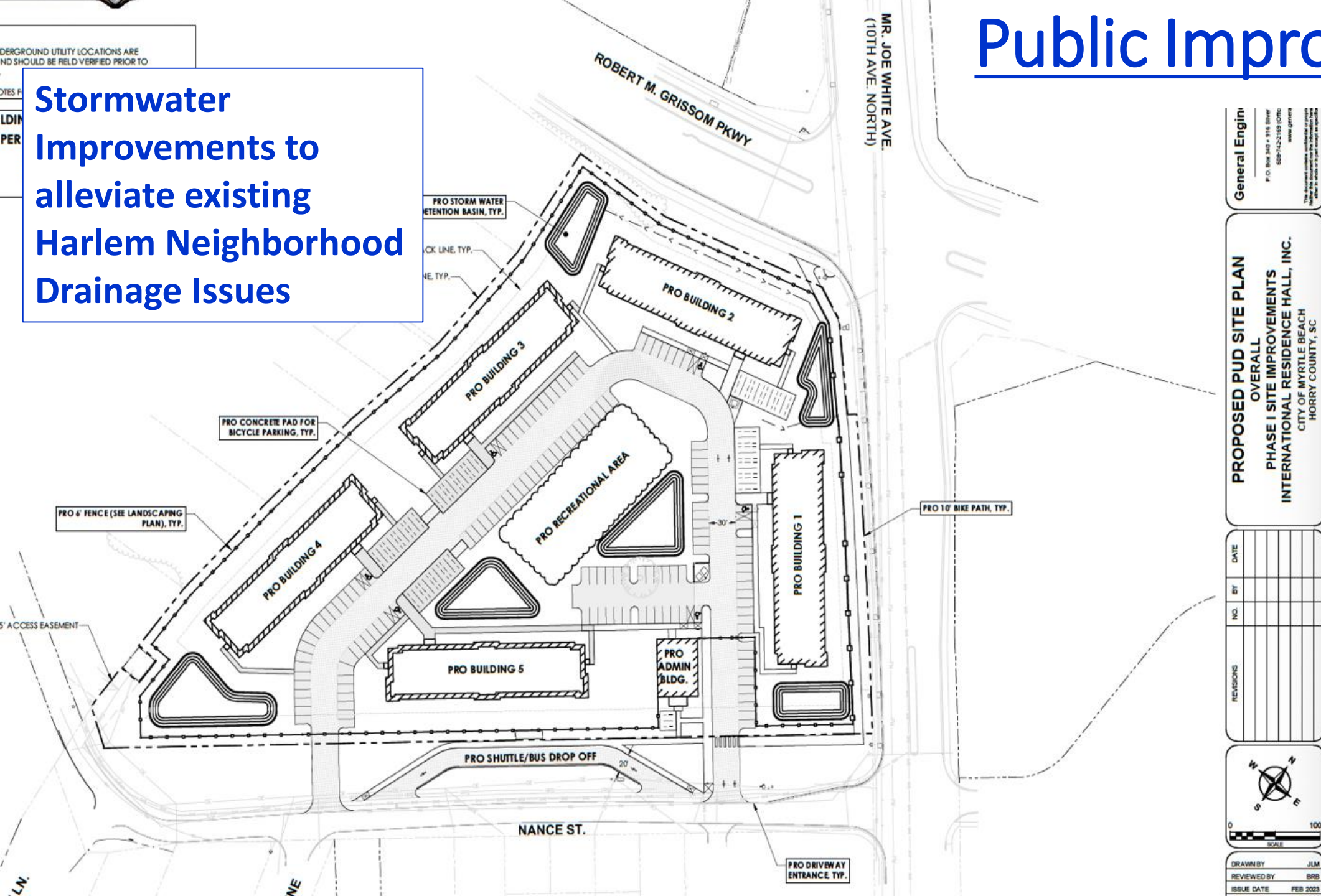

# Public Improvements

Stormwater  
Improvements to  
alleviate existing  
Harlem  
Neighborhood  
Flooding

New Bicycle Path  
to Connect to the  
East Coast  
Greenway

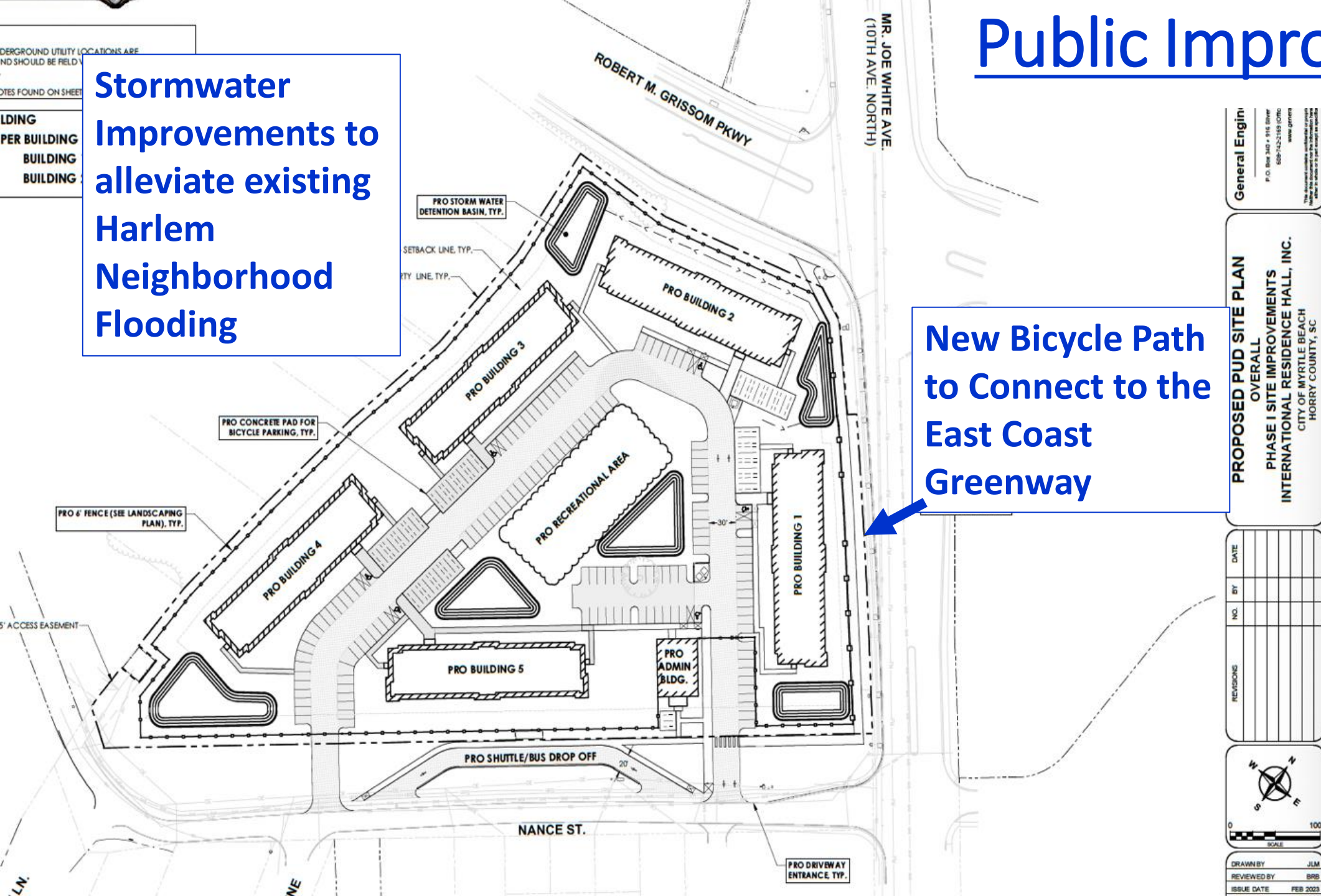



# Public Improvements

Stormwater Improvements to alleviate existing Harlem Neighborhood Flooding

Coast RTA Bus Shelter & Ride Share Pick Up/Drop Off

New Bicycle Path to Connect to the East Coast Greenway

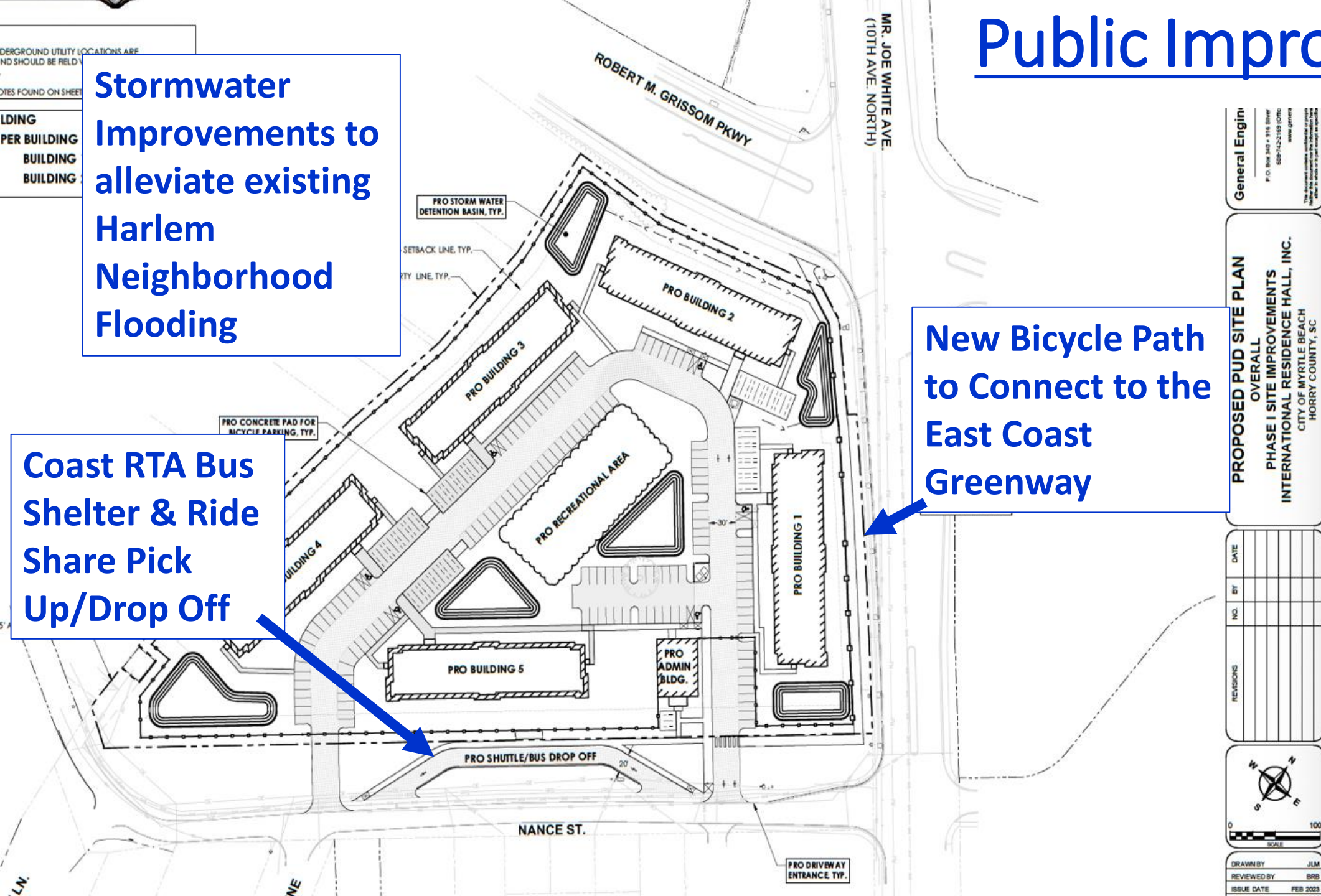



# Public Improvements

Stormwater Improvements to alleviate existing Harlem Neighborhood Flooding

Coast RTA Bus Shelter & Ride Share Pick Up/Drop Off

New Bicycle Path to Connect to the East Coast Greenway

Mr. Joe White Ave Turning Improvements

